

TECHNICAL DATA

SINGLE DIRECTION VIBRATORY PLATES

BVP 18/45, BVP 18/45 D



Compact

Guide handle fully foldable



Robust and reliable

V-belt all around protected against damage



Safe transport

Transport handles (standard) and transport wheels (optional)

Shipping dimensions in m3

BVP 18/45	0,149
BVP 18/45 D	0,181

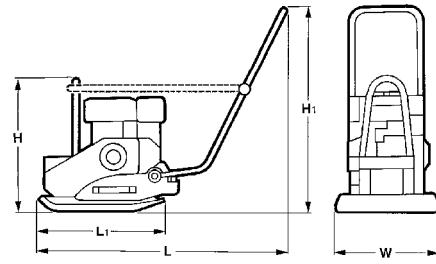

Standard Equipment

- Vibration insulated steering bow, foldable
- Detachable steering handle
- Highly wear resistant base plate
- Automatic shutdown at low oil level (BVP18/45)
- Recoil starter
- Single point lifting device
- Fully protected V-belt
- Carrying handles
- 3-2-1 Warranty
- Engine protection frame (BVP18/45D)
- Automatic decompression (BVP18/45D)

Dimensions in mm

	H	H1	L	L1	W
BVP 18/45	535	915	1115	558	450
BVP 18/45 D	650	915	1115	558	450

Optional Equipment

- Sprinkler system (+7kg)
- Transport wheels (+4kg)
- Plastic mat
- Tool kit
- Service Kit
- TOUGH WARRANTY
- Comfort guide handle
- Special painting
- Engine protection frame (BVP18/45)

Technical Data

Weights

Operating weight CECE	kg	91	104
Basic weight	kg	90	103

Dimensions

Working width	mm	450	450
---------------------	----	-----	-----

Driving Characteristics

Working speed, max.	m/min	25	25
Max. gradeability (dep. on soil con.)	%	30	30

Drive

Engine manufacturer		Honda	Hatz
Type		GX 160	1B20
Emission stage		StageV/CARB P.3	Stage V
Cooling		air	air
Number of cylinders		1	1
Performance SAE J 1349	kW	3,6	
Performance ISO 3046	kW		3,1
Speed	min-1	3.600	3.000
Drive system		mech.	mech.
Fuel		Gasoline	Diesel
Fuel comsump. aver. during operation	l/h	1,1	0,7

Exciter system

Frequency	Hz	90	90
Centrifugal force	kN	18	18
Amplitude	mm	1,63	1,63

Capacities

Fuel	l	3,1	3,0
Water	l	7,0	7,0

Technical modifications reserved. Machines may be shown with options.



PRE 834 12 010

300120 Sa05

BOMAG
 Hellerwald
 D-56154 Boppard
 P.O. Box 5162
 Tel. (0)6742 - 1000
 Fax (0)6742 - 3090

